

PM Conformity Hot Spot Analysis – Project Summary for Interagency Consultation

<b>RTIP ID#</b> LALS06					
<b>TCWG Consideration Date</b> <del>February 22, 2022</del> <del>January 28, 2020</del>					
<p><b>Project Description</b> <i>(clearly describe project)</i>                  The project proposes to widen the southbound Interstate 405 (I-405) on-ramp at Ventura Boulevard (Blvd). The on-ramp will be modified from a Single Occupant Vehicle (SOV) lane plus one High Occupancy Vehicle (HOV) lane to a <del>three metered SOV lanes</del> <del>two lane SOV plus one HOV on-ramp</del>. A new curb ramp at the beginning of the ramp entrance needs to be constructed as a result of widening the on-ramp. <u>Provision is made for the relocation of light poles, control boxes, and irrigation systems.</u> A paved Maintenance Vehicle Pullout (MVP) is also recommended to be constructed upstream of the metering controller cabinet.</p> <p><i>(see attached project plans and layouts)</i></p>					
<p><b>Type of Project</b> <i>(use Table 1 on instruction sheet)</i>                  Intersection Channelization</p>					
<b>County</b> LA	<p><b>Narrative Location/Route &amp; Postmiles</b>                  The proposed project is located on Interstate 405 (I-405) southbound on-ramp at Ventura Blvd in the community of Sherman Oaks in the City of Los Angeles, Los Angeles County (Post Mile 39.09).</p> <p><b>Caltrans Projects – EA#</b> 20490</p>				
<b>Lead Agency:</b> Caltrans					
<b>Contact Person</b> Andrew Yoon	<b>Phone#</b> 213-266-6892	<b>Fax#</b> 213-897-0683	<b>Email</b> Andrew_yoon@dot.ca.gov		
<b>Hot Spot Pollutant of Concern</b> <i>(check one or both)</i> <b>PM2.5 x</b> <b>PM10 x</b>					
<b>Federal Action for which Project-Level PM Conformity is Needed</b> <i>(check appropriate box)</i>					
x	Categorical Exclusion (NEPA)	EA or Draft EIS	FONSI or Final EIS	PS&E or Construction	Other
<b>Scheduled Date of Federal Action:</b> March 2020					
<b>NEPA Assignment – Project Type</b> <i>(check appropriate box)</i>					
Exempt		x Section 326 – Categorical Exemption	Section 327 – Non-Categorical Exemption		
<b>Current Programming Dates</b> <i>(as appropriate)</i>					
	<b>PE/Environmental</b>	<b>ENG</b>	<b>ROW</b>	<b>CON</b>	
<b>Start</b>	12/3/2018 <del>December 2018</del>	3/26/2020 <del>March 2020</del>	4/16/2020	5/26/2022 <del>July 2022</del>	
<b>End</b>	4/1/2020 <del>March 2020</del>	12/20/2021 <del>September 2021</del>	2/28/2022 <del>September 2021</del>	7/1/2024 <del>July 2024</del>	

**Project Purpose and Need (Summary):** *(attach additional sheets as necessary)*

The purpose of the proposed project is to enhance operating conditions at southbound Interstate (I-405) on-ramp at Ventura Boulevard (Blvd). ~~The southbound Ventura Blvd on-ramp to I-405 is currently operating at LOS F during peak hours, with a current ADT of 6,200 vehicles and truck percentage of 2 percent.~~ The southbound I-405 at the project location consists of 5 Mixed Flow Lanes (MFL) and a High Occupancy Vehicle (HOV) lane. The on-ramp consists of two single SOV lanes that merges to one lane near the ramp gore area. Traffic entering the southbound Ventura Boulevard on-ramp from westbound Ventura Boulevard is creating queuing upstream of the ramp meter and onto the city surface street. The extensive queuing blocks access to a nearby bus stop pocket and causes buses to overflow and block the adjacent through traffic movements, which subsequently results in additional congestion and weaving issues from the opposing traffic that utilizes the same on-ramp access. Queues have been observed extending up the on-ramp and onto Ventura Blvd and reaching as far downstream as Sepulveda Blvd and block that intersection. The two-lane terminus is approximately 40 meters long and provides little storage capacity along the on-ramp. Due to the critical location of this segment along I-405 and the importance of providing acceptable operations for commuters, the proposed improvements at this on-ramp are anticipated to enhance the existing conditions at the Ventura Boulevard intersection.

**Surrounding Land Use/Traffic Generators** *(especially effect on diesel traffic)*

Land uses along Ventura Blvd near the project limits predominantly include single and multi-family residential as well as commercial uses. The Sherman Oaks Galleria is located nearby at Sepulveda Blvd/Ventura Blvd intersection.

PM Conformity Hot Spot Analysis – Project Summary for Interagency Consultation

**Opening Year: If facility is an interchange(s) or intersection(s), Build and No Build cross-street AADT, % and # trucks, truck AADT**

**ADT = 6,2406,300; Truck % = 2%**

	Direction		Peak Hour Volumes		LOS		Delay	
			AM	PM	AM	PM	AM	PM
<b>Opening Year (2024)</b>	Northbound Sherman Oaks Ave	LT	99	84	F	F	91.5	127.4
		T	574	587				
		RT	197	168				
	I-405 Ventura Off-Ramp	LT	80	77				
		T	562	540				
		RT	161	154				
	Eastbound Ventura Blvd	LT	180	195				
		T	1262	1365				
		RT	361	390				
	Westbound Ventura Blvd	LT	171	232				
		T	1194	1626				
		RT	341	465				

*Notes: Build and No-Build are the same*

	Direction		Peak Hour Volumes		LOS		Delay	
			AM	PM	AM	PM	AM	PM
<b>Opening Year (2025)</b>	Northbound Sherman Oaks Ave	LT	202	173	E	D	71	47
		T	22	17				
		RT	202	173				
	I-405 Ventura Off-Ramp	LT	323	254				
		T	50	51				
		RT	323	250				
	Eastbound Ventura Blvd	LT	278	163				
		T	1171	1604				
		RT	362	203				
	Westbound Ventura Blvd	LT	172	235				
		T	895	1922				
		RT	647	190				

*Note: Build and No-Build data are the same*

RTP Horizon Year / Design Year: If facility is an interchange (s) or intersection(s), Build and No Build cross-street AADT, % and # trucks, truck AADT

ADT = ~~6,330~~6,600; Truck % = 2%

	Direction		Peak Hour Volumes		LOS		Delay	
			AM	PM	AM	PM	AM	PM
Design Year 2044	Northbound Sherman Oaks Ave	LT	100	85	F	F	104.6	134.7
		T	583	596				
		RT	200	170				
	I-405 Ventura Off- Ramp	LT	82	78				
		T	571	549				
		RT	163	157				
	Eastbound Ventura Blvd	LT	183	198				
		T	1281	1385				
		RT	366	396				
Westbound Ventura Blvd		LT	173	236				
		T	1212	1650				
		RT	346	471				

Note: Build and No-Build are the same

	Direction		Peak Hour Volumes		LOS		Delay	
			AM	PM	AM	PM	AM	PM
Design Year 2045	Northbound Sherman Oaks Ave	LT	206	179	E	E	76	62
		T	23	18				
		RT	206	179				
	I-405 Ventura Off-Ramp	LT	330	263				
		T	52	53				
		RT	330	263				
	Eastbound Ventura Blvd	LT	284	169				
		T	1196	1658				
		RT	370	210				
	Westbound Ventura Blvd	LT	175	243				
		T	913	1988				
		RT	661	196				

Note: Build and No-Build are the same

**Describe potential traffic redistribution effects of congestion relief (impact on other facilities)**

The goal of the project is to improve the operational condition of the southbound Ventura Blvd on-ramp. This will be accomplished by increasing on-ramp vehicle storage capacity through widening the ramp to create ~~two SOV lanes and one HOV lanes~~ **three SOV lanes**. Project improvements are not expected to result in redistribution of traffic to or from adjacent interchanges nor have a considerable effect on other facilities.

**Comments/Explanation/Details (attach additional sheets as necessary)**

The project proposes to widen the southbound I-405 on-ramp at Ventura Blvd. Proposed project is anticipated to enhance operating conditions at the southbound Ventura Blvd on-ramp. Based on the traffic data identified above, the proposed project is not anticipated to result in new or worsened PM2.5 or PM10 violations. Therefore, the project is considered not to be of air quality concern for PM2.5 and PM10.

STATE OF CALIFORNIA - DEPARTMENT OF TRANSPORTATION  
**Stantec**  
**DESIGN C**

FUNCTIONAL SUPERVISOR  
 REFUGIO DOMINGUEZ

CALCULATED BY  
 DESIGNED BY  
 CHECKED BY

MADELINE WCHA  
 REFUGIO DOMINGUEZ

REVISED BY  
 DATE REVISED

**NOTES:**

1. FOR ACCURATE RIGHT OF WAY DATA, CONTACT RIGHT OF WAY ENGINEERING AT THE DISTRICT OFFICE.

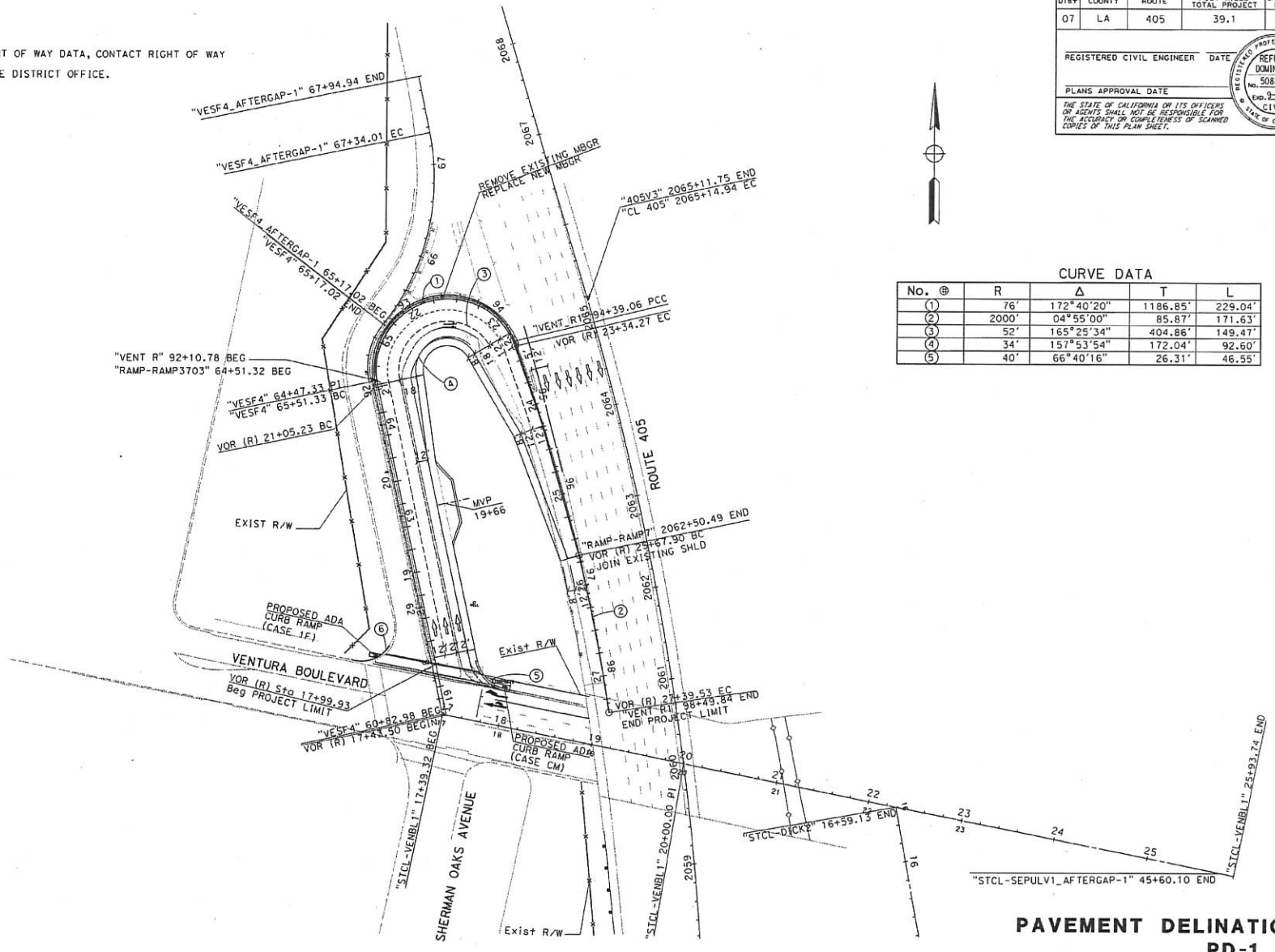

DIST	COUNTY	ROUTE	POST MILES TOTAL PROJECT	SHEET No.	TOTAL SHEETS
07	LA	405	39.1	x	

REGISTERED CIVIL ENGINEER DATE \_\_\_\_\_  
 PLANS APPROVAL DATE \_\_\_\_\_  
 THE STATE OF CALIFORNIA OR ITS OFFICERS OR AGENTS SHALL NOT BE RESPONSIBLE FOR THE ACCURACY OR COMPLETENESS OF SCANNED COPIES OF THIS PLAN SHEET.

REGISTERED PROFESSIONAL ENGINEER  
 REFUGIO DOMINGUEZ  
 No. 50829  
 Exp. 2-30-21  
 CIVIL  
 STATE OF CALIFORNIA

**CURVE DATA**

No. @	R	Δ	T	L
1	76'	172°40'20"	1186.85'	229.04'
2	2000'	04°55'00"	85.87'	171.63'
3	52'	165°25'34"	404.86'	149.47'
4	34'	157°53'54"	172.04'	92.60'
5	40'	66°40'16"	26.31'	46.55'

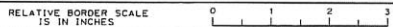

BORDER LAST REVISED 7/2/2010

USERNAME => r133273  
 DCN FILE => 0720490na001.cgn

UNIT 1819

PROJECT NUMBER & PHASE

071700022

LOI: 000001 DATE PLOTTED => 20-MAR-2020  
 00-00-00 TIME PLOTTED => 09:18